

2018



GREAT LAKES RESOURCE SHARING CONFERENCE

Charting Our Course Together

Perrysburg, Ohio, June 7 & 8, 2018

From the Chairs

*Welcome to Perrysburg!
We're excited to have you
join us for our 5th Great
Lakes Resource Sharing
Conference. We're looking
forward to a great event.*



PLANNING COMMITTEE

Shelly Miller (co-chair), OhioNET
Linda Brown (co-chair), Bowling Green State University
Cathy Bartel, Toledo Lucas County Public Library
Jeff Brunner, WiLS
Margaret Chambers, Consortium of Academic Research Libraries of Illinois (CARLI)
Cen Cheng, Michigan State University
Meghan Frazer, Scribd
Amanda Musacchio, Reaching Across Illinois Library System (RAILS)
Mark Sullivan, IDS Project-SUNY Geneseo
Randy Dykhuis, Midwest Collaborative for Library Services
Heather Ladiski, Midwest Collaborative for Library Services

#glrsc18

Thank You to Our Sponsors



Venue Map

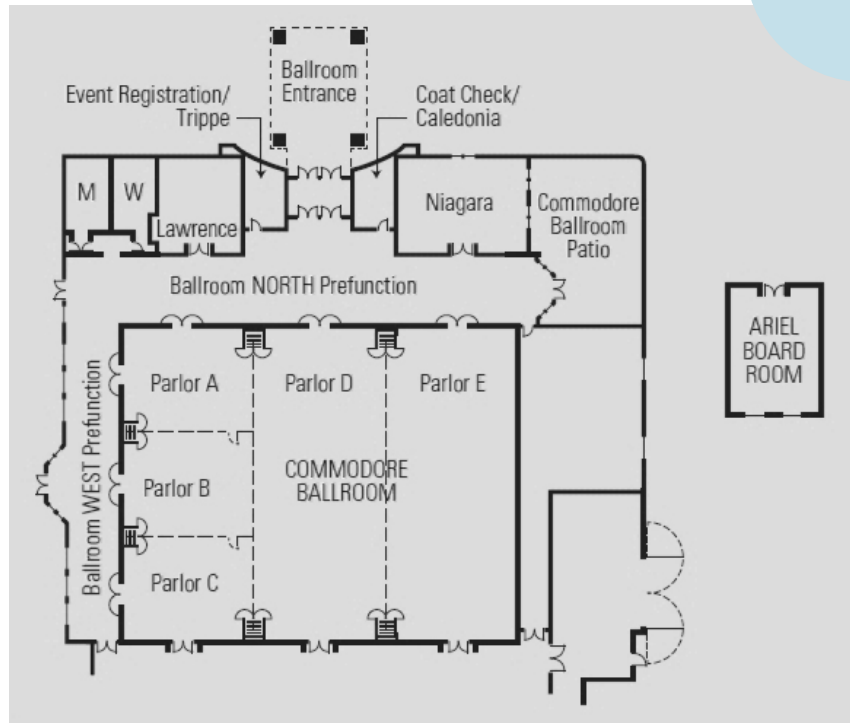

Thursday, June 7

All plenary events take place in Parlor D

12:30 PM - Registration Opens

1:15 PM - Welcome and Overview

1:30 PM - 3:00 PM

Parlor D

Lightning Talks

Join us for this set of rapid-fire discussions. Each talk lasts just 15 minutes and provides a great opportunity for first-time speakers and a format ideal for quick updates, tips and suggestions. This year's lightning talks will cover traditional ILL topics, like workflow improvements, but will also touch on more cutting-edge concepts like open textbooks and license management.

Northwest Ohio Regional Book Depository Tour

The depository is specially designed for the remote storage and retrieval of little-used, but important, library materials belonging to Bowling Green State University and the University of Toledo. The tour will showcase our high-density, climate-controlled storage module, holding about 1.25 million items, and describe how we organize and circulate the items in our care.

3:00 PM – 3:30 PM Break

3:30 PM – 5:00 PM

Parlor D

OCLC Resource Sharing Update

Alena Miller and Annie Silva, OCLC

(session ends at 4:30)

Join Alena Miller and Annie Silva from OCLC's Resource Sharing team for an update on what's new and coming soon with WorldShare ILL and Tipasa. Alena will give an overview of the Tipasa implementation program and suggest some great ways to keep up on OCLC news and events. Annie will review the customer support process, including what you can expect when you contact OCLC for help and how to track progress on your support ticket.

Northwest Ohio Regional Book Depository Tour

The depository is specially designed for the remote storage and retrieval of little-used, but important, library materials belonging to Bowling Green State University and the University of Toledo. The tour will showcase our high-density, climate-controlled storage module, holding about 1.25 million items, and describe how we organize and circulate the items in our care.

4:30 PM – 5:00 PM Day 1 Closing Session

5:00 PM – 6:00 PM Networking Reception

Niagara Room

Come meet your colleagues in a casual setting to wrap up the first day of the conference. Win prizes while meeting your colleagues. Light appetizers will be provided and a cash bar will be available.

6:30 PM Dinearounds

Multiple Locations

Be sure you sign up before 5:30 pm Thursday to share dinner with GLRSC colleagues at one of the Dine-Arounds. Sign-up sheets are at the Registration table. [See options on the GLRSC website.](#)

Friday, June 8

All plenary events take place in Parlor D

8:00 AM - 9:00 AM - Registration

9:00 AM - Welcome, Overview and Keynote Introduction

9:00 AM - 10:00 AM - Keynote Address

Parlor D

Promises and Pitfalls of 21st Century Resource Sharing

George Needham, Director, Delaware County District Library

Whether you call it resource sharing or interlibrary loan or document delivery, librarians have shown a long history of exchanging materials between institutions to better serve their users. But let's stop for a moment to consider how unusual this behavior is in the world beyond libraries. Do corporate entities share their assets? Do most government agencies willingly circulate their best resources with clients of other agencies? Do academic departments in a university collaborate without serious compunction?

So how did resource sharing become part of the librarian's DNA? In this presentation, George Needham will discuss the roots of interlibrary loan in the early 20th century, consider the impact of technology in the forms of the MARC record, OCLC, and the web, and then look at what forms resources sharing may take in the years to come. Will economic pressure force us to collaborate even more radically, or will it lead to a new bunker mentality? Could libraries serve as "showrooms for information" in the future? And what would happen if, in the words of some cynical observers, everything really *was* available on the web?

10:00 AM - 10:15 AM - Break

10:15 AM - 11 AM - Concurrent Sessions I

Parlor A

Transition complete: A Mid-size academic library's challenges and triumphs in moving from ILLiad to Tipasa

Derek Malone, University of North Alabama

In the spring of 2017 we began our mid-size academic library transition from ILLiad to Tipasa. There were questions and challenges before, during, and after the process, but at present time, we feel that we are in a good place regarding our services. This presentation will cover some of the questions and challenges we had, how we have changed our services, what we are looking into modifying moving forward, and what we really like about the move.

#glrsc18

Parlor B

Open Ohio: Affordable Learning Initiatives at Scale

Anna Bendo, OhioLINK and Steve Kaufman, University of Akron

Library consortia are increasingly taking the lead in OER and affordable learning initiatives for member institutions. Collaborative use of shared e-books and other alternative textbook materials, shared metadata and licensing expertise, and hosting platforms for authorship of OER build on existing networks of shared resources and services. This session will describe how OhioLINK leverages these existing networks and experiences to build robust support for OER and Affordable Learning at the statewide level.

Cancelled - Slides will be posted on glrsc.org.

Lending OERs and Learning Objects - 21st Century Library Content Curation & Management in a Semantic Metadata Context

Tom Adamich, Visiting Librarian Service

The goal of this session is to highlight existing OER/ learning object content curation and management best practices (with a focus on OER/learning object metadata acquisition, evaluation, and distribution workflows and strategies). We will explore how these practices can optimize OER/learning object utilization (at lesson, unit, and/or course delivery levels) and encourage additional OER/learning object modification -- creating new versions of the original OER/learning objects that have the potential to be curated and widely distributed in their new, modified forms.

11:00 AM - 11:15 AM - Break

11:15 AM - 12:00 PM - Concurrent Sessions II

Parlor A

Using ILL requests to make decisions on journal subscriptions

Holli Moseman, Indiana State University

Indiana State University uses ILL data to see if journal subscriptions should be added to the collection. In this session, attendees will learn about the kind of data collected and how it can be used by collection development.

Parlor B

Using the Digital Public Library to Share Ohio's Treasures with the World

Jen Johnson, State Library of Ohio

Curious about DPLA and our collaborative Hub, Ohio Digital Network? Bring your questions to this session, where we will cover the history and goals of DPLA, the material that Ohio has already contributed to it, and how we can utilize the site to share Ohio's digitized collections across the state and the globe.

Parlor C

The Silent Partner in Resource Sharing ...Delivery

Susan Palmer, CARLI and Mark Hatch, RAILS

Challenging economic times scream for creative solutions. This truism also applies to libraries and how they share their items. But how is that accomplished? US Mail? FedEx? Drones? The reality is that somehow, someday, those physical items must be transported from library to library. Come have a conversation with two seasoned delivery professionals from Illinois. No matter what your current delivery situation is, you will gain practical tips to improve your delivery system.

12:00 PM - 1:15 PM Lunch

1:15 PM - 2:00 PM - Concurrent Sessions III

Parlor A

Resource Sharing: Learning the ropes for beginners

Holli Moseman, Indiana State University

This session will give an overview about Resource Sharing; including borrowing, lending, document delivery, distance education learners, specialized programs like on demand purchasing and getting the most for your dollar.

Parlor B

You're On Track: OBILLSK, Consolidated Shipment Tracking, and You

Cen Cheng, Michigan State University and Jonathan Callies, Michigan State University

This session provides an overview of the "Online-Based Interlibrary Loan Statistical Kit," or "OBILLSK" for short. OBILLSK is a subscription-based system designed by Texas Tech University that provides a single web-based portal for inputting, tracking, and assessing all ILL shipments regardless of the shipper chosen. Not only can OBILLSK help libraries save money in lost book fees, the consolidated tracking system also provides libraries with greater control over shipping procedures, methodology, and overall statistical analysis.

Parlor C

The persistence of library users: the story of transaction logs vs. ILL requests

Sherri Michaels, Indiana University and Rachael Cohen, Indiana University

How persistent are library users in obtaining the material that they want? If they search the catalog for a known-item, but get zero results, what will they do next? Will they place an interlibrary loan request or just move on to another more available item? This session will present the results of a study at Indiana University to determine the persistence of library users in obtaining known items.

2:00 PM - 2:15 PM - Break

2:15 PM - 3:00 PM - Concurrent Sessions IV

Parlor A

Integrating ILLiad Reports with Data from Other Silos

Christopher White, The Sage Colleges

This session will address current practice in integrating data from different silos. Topics covered will include the the logistics of doing so but also the ethical bounds of how much information libraries should collect on user behavior.

Parlor B

Promotion and Uses of Reciprocal Borrowing as viewed by the Provider and the Patron

Kathleen Rhoades, Dominican University and Briana Love, Graduate Student, Dominican University

Interlibrary Loan Coordinator Kathleen Rhoades will present how she uses the tools available to her to market ILL and Reciprocal Borrowing to patrons and other institutions. Graduate Student and past library student worker Briana Love will explain her experiences in accessing materials for her student work. She will also discuss how working with ILL helped her identify available resources and build her skills need for graduate school. Relevance of identifying available sources both internal and external for marketing ILL/Resource Sharing practices.

Parlor C

Collaborative Data-driven Decision Making: Buy, Cancel or Renew

Jessica Morales, University of Toledo, Sheryl Stevens, University of Toledo, and Valerie Brown, University of Toledo

During 2018, the University Libraries at The University of Toledo set out to couple subject expertise with usage data to drive new acquisition, renewal, and cancellation decisions for all electronic resources. This presentation will cover the role of usage and ILL metrics in acquisition decisions as well as the workflow processes behind data gathering, evaluation, and decision-making.

3:00 PM - 3:45 PM - Closing Plenary

Closing refreshments, door prizes, and adjourn

Volunteer to plan GLRSC 2019!

The GLRSC Planning Committee is looking for volunteers for the 2019 Conference. Interested?

[Please complete this online form.](#)

#glrsc18

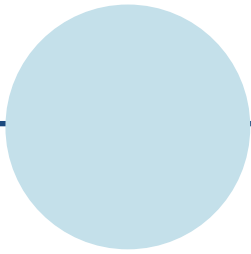

2018 Interns

BRIANA LOVE

Briana Love is a graduate student at Dominican University. She holds a B.A. in American Studies and is currently pursuing her Masters of Library and Information Science degree. Briana currently works as a Reference Assistant at Dominican University, where she assists students, faculty, and staff to navigate through online databases and other online catalogs. In the future, Briana intends to become an Access Services Librarian in an academic institution. She lives in Chicago, Illinois and enjoys reading comics, manga, and mystery novels.

SARAH MYERS

Past work with marginalized individuals has shaped Sarah's professional and academic goals. She has worked extensively with at-risk adolescents as an Urban Youth Development Peace Corps volunteer in Ecuador and as direct care staff and independent living skills instructor at a group home for at-risk teenage girls in Youngstown, Ohio. Through these experiences Sarah has built relationships with countless young, insatiable readers. These children have inspired her to pursue her MLIS with a teen services specialization at the Kent State University iSchool. Sarah's expected graduation is May 2019. Currently she is working as an Outreach library specialist at Warren-Trumbull County Public Library in Warren, Ohio where she enjoys serving Homebound and Bookmobile customers. Her plans are to continue outreach work and to explore prison librarianship to further her interest in serving marginalized individuals. Additionally, learning about other aspects of library science and meeting professionals with practical experience and insight interest Sarah. During study breaks, two of her favorite hobbies are writing letters to close friends and riding her motorcycle.

ERIN ZIMMERMAN

Erin Zimmerman works as a Library Technical Assistant - Technical Services at the Heartland Community College Library in Normal, IL. There she is responsible for Interlibrary Loan, Collection Management, Reserves, and Acquisitions. She is pursuing her MLIS degree online through Wayne State University and plans to graduate in May 2019 with a graduate certificate in Archival Administration.